

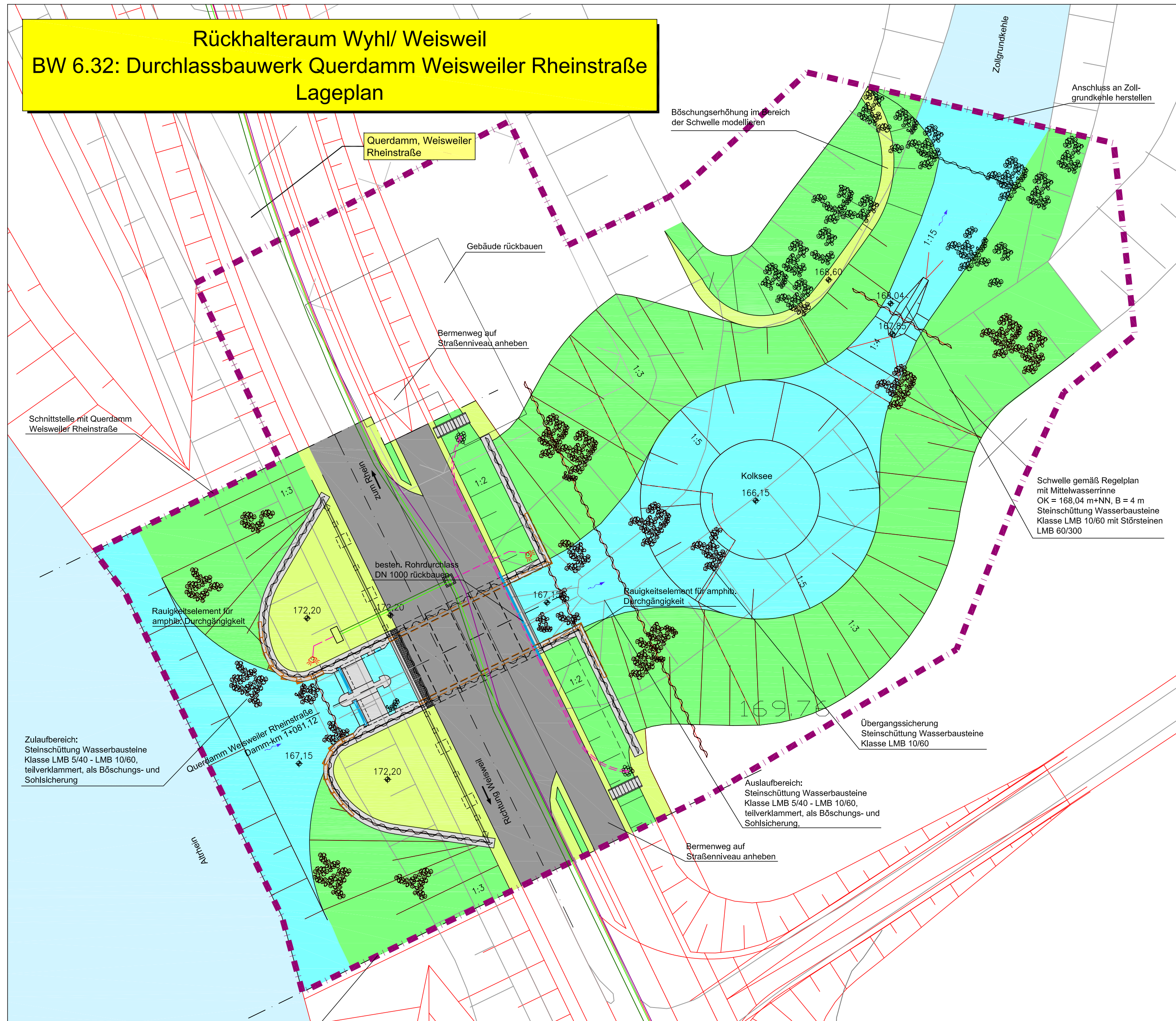













Rückhalteraum Wyhl/ Weisweil  
BW 6.32: Durchlassbauwerk Querdamm Weisweiler Rheinstraße  
Lageplan



Legende:

- |   |                     |   |  |
|---|---------------------|---|--|
|  | Bestandshöhe [m+NN] |  | (Damm-) Böschung                                 |
|  | Planungshöhe [m+NN] |  | Gewässer   |
|  | Planung             |  | Bauwerk, Beton                                   |
|  | Bestand             |  | Bankett, Berme                                   |
|  | Achse               |  | Asphalt-, Pflaster-, Schotterweg                 |
|  | Spundwand           |  | Rauigkeitselement für amphib.<br>Durchgängigkeit |
|  | Baukorridor         |   |  |

Leitungen Planung:

- 20 kV Erdleitung
- 0,4 kV Erdleitung
- LWL-Steuerkabel im Leerrohr
- - - - - Leerrohr

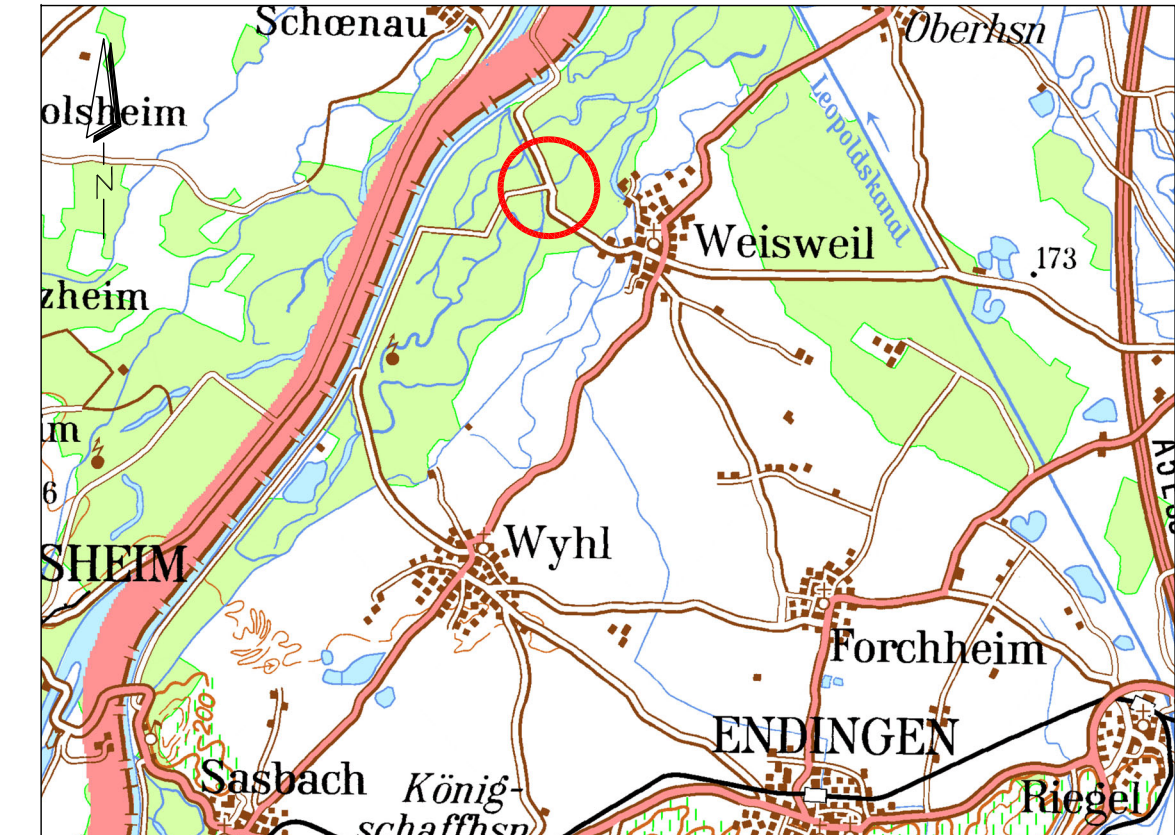
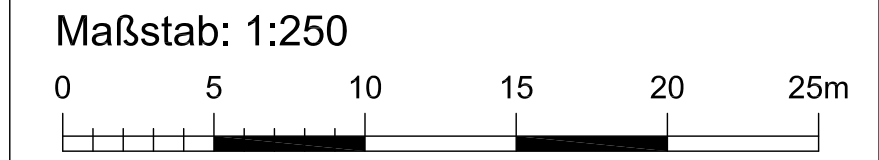

f	-	-	-
e	-	-	-
d	-	-	-
c	-	-	-
b	-	-	-
a	Sa	29.02.2024	Rauigkeitselement für amphib. Durchgängigkeit
Index	Name	Datum	Änderung

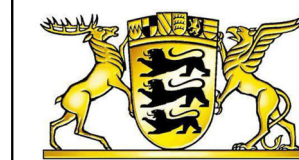

REGIERUNGSPRÄSIDIUM FREIBURG  
Abteilung Umwelt



## Rückhalteraum Wyhl/Weisweil

**BW 6.32: Durchlassbauwerk Querdamm Weisweiler Rheinstraße**

## Lageplan



Ingenieurbüro für Wasserbau, Wasserrwirtschaft und Tiefbau  
**BERATENDE INGENIEURE**  
Am Hecklehamm 18 76549 Hügelsheim  
Telefon (07229) 1876-00 Telefax (07229) 1876-77

Regierungspräsidium Freiburg  
Abteilung Umwelt  
Ref. 53.3, "Integriertes Rheinprogramm"  
Bissierstr. 7, 79114 Freiburg

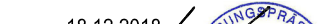
bearb.:	1.07.2010	Ro/Sk	zum Antrag vom <u>18.12.2018</u> gehörend	
gez.:	1.07.2010	Sk/Ste		
gepr.:	1.07.2010	Ro		

Maßstab: 1:250	Freiburg, den 29.02.2024
Plan Nr.: 13/038/02/02	Anlage: 11.3 Blatt: 1a